

FILE: \\Jobstuff\Jobsdata\82601.00 Eek Solid Waste Facility\00 CADD\02 Figures\CORP Vicinity Map .dwg

U.S. ARMY CORPS OF ENGINEERS ALASKA DISTRICT
 2204 3RD STREET
 JBER, ALASKA 99506-0898

AGENT:
 CRW ENGINEERING GROUP, LLC
 3940 ARCTIC BLVD. SUITE 300
 ANCHORAGE, AK 99503

**EEK SOLID WASTE FACILITY
 EEK, ALASKA**

VICINITY MAP

LOCATION: EEK, AK
 SEWARD MERIDIAN T2N R73W
 SECTIONS 31 AND 32

STATUS: PERMITTING
 DATE: 10/21/2013 FIGURE:

LOCATION: EEK, AK
 SEWARD MERIDIAN T2N R73W
 SECTIONS 31 AND 32
 STATUS: PERMITTING
 DATE: 10/21/2013
 FIGURE:

**EEK SOLID WASTE FACILITY
 EEK, ALASKA
 PROPOSED LANDFILL**

U.S. ARMY CORPS OF
 ENGINEERS ALASKA DISTRICT
 2204 3RD STREET
 JBER, ALASKA 99506-0898
 AGENT:
 CRW ENGINEERING GROUP, LLC
 3940 ARCTIC BLVD. SUITE 300
 ANCHORAGE, AK 99503

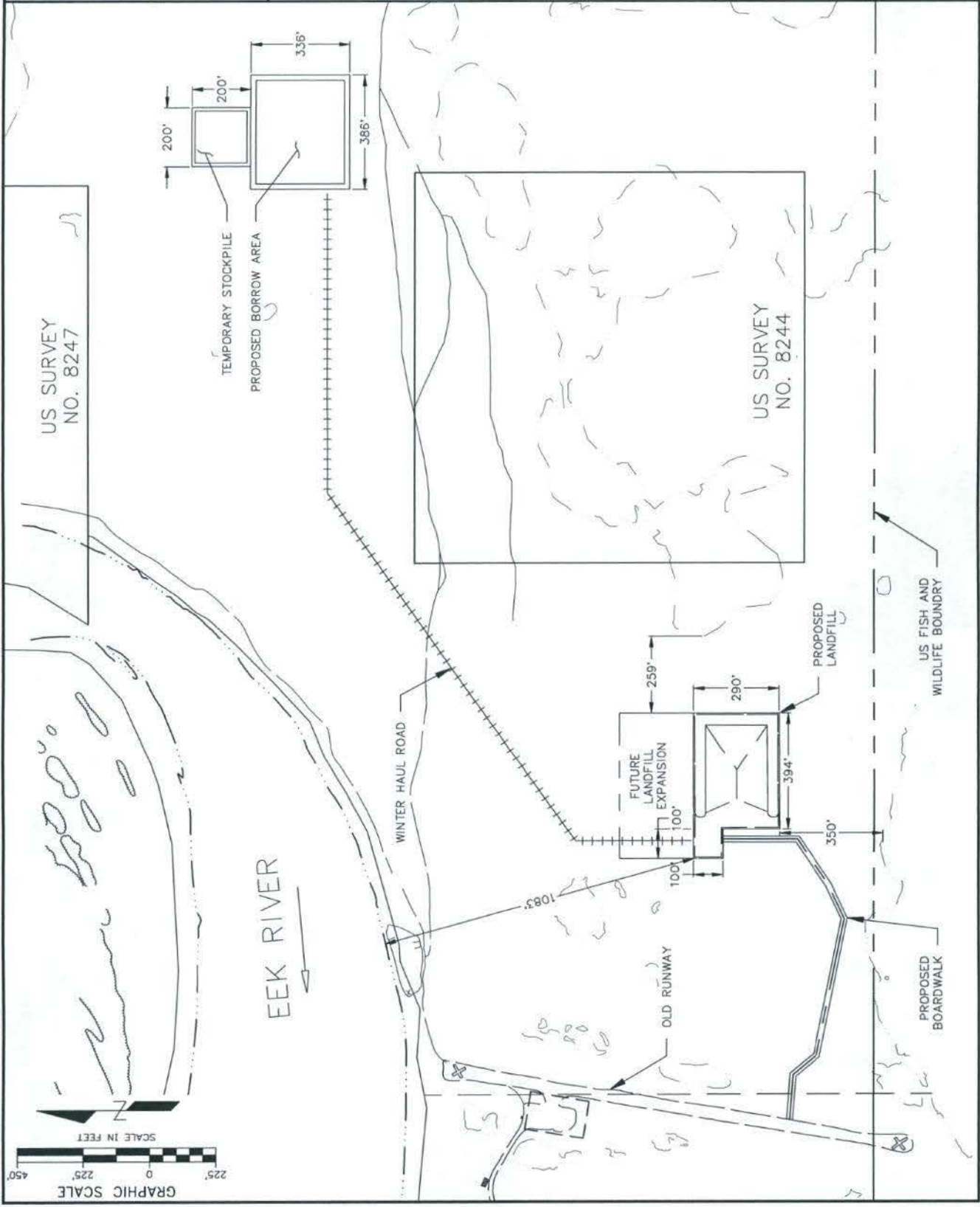

FILE: \\Jobsurft\Jobsdata\82601.00 Eek Solid Waste Facility\00 CADD\01 Working Set\01 Civil\82601.00 LandfillSitePlan.dwg

FILE: \\Jobsturf\Jobdata\82601.00 Eek Solid Waste Facility\00 CADD\02 Figures\CORP Vicinity Map .dwg

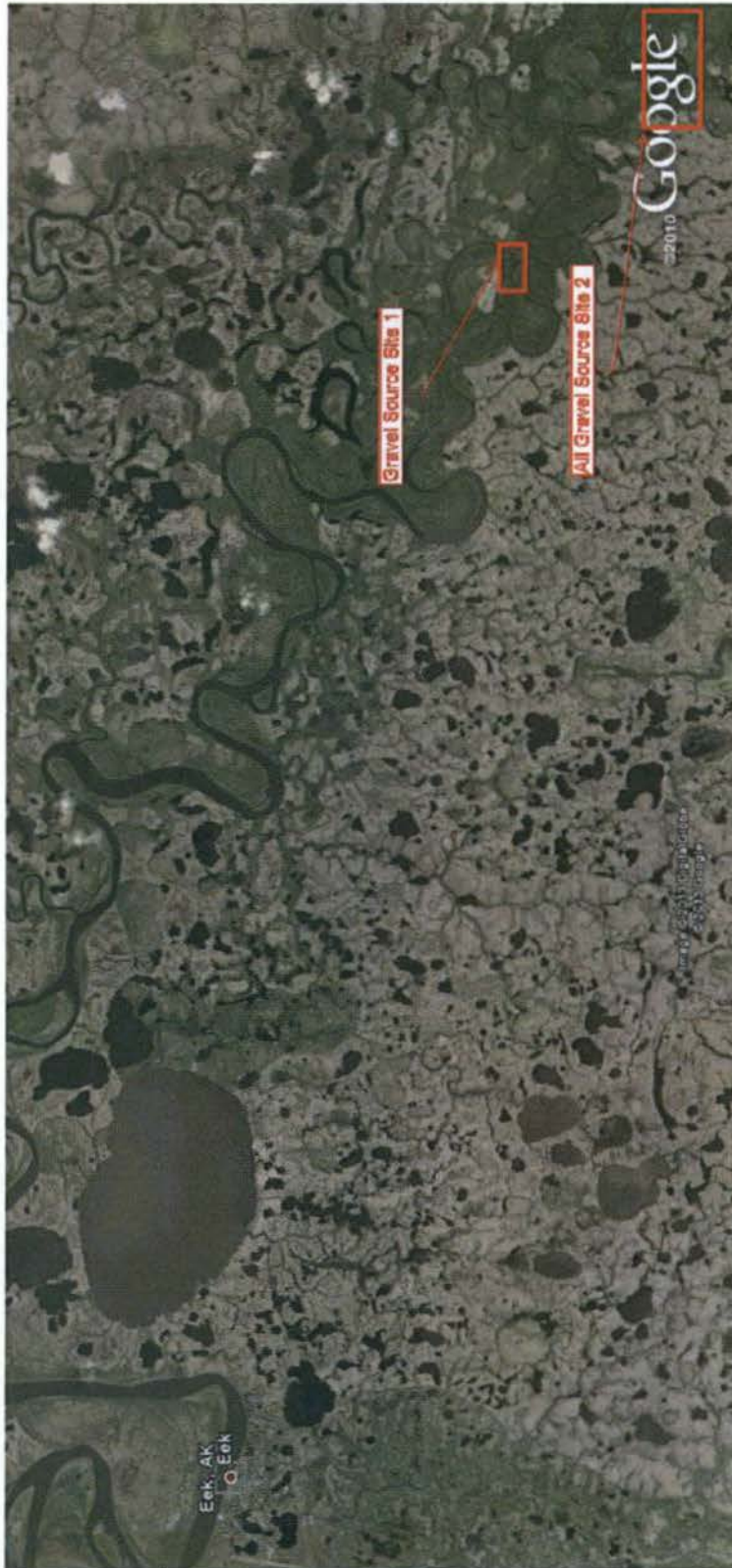

10/18/2013

POA-2013-567, Eek River, Sheet 3 of 8, dated October 21, 2013

U.S. ARMY CORPS OF
ENGINEERS ALASKA DISTRICT
2204 3RD STREET
JBER, ALASKA 99506-0898

AGENT:
CRW ENGINEERING GROUP, LLC
3940 ARCTIC BLVD, SUITE 300
ANCHORAGE, AK 99503

EK SOLID WASTE FACILITY EEK, ALASKA

GRAVEL OVERVIEW MAP

LOCATION: EEK, AK
SEWARD MERIDIAN T2N R73W
SECTIONS 31 AND 32

STATUS: PERMITTING

DATE: 10/21/2013

FIGURE:

FILE: \\Jobstuff\Jobsdata\82601.00 Eek Solid Waste Facility\00 CADD\02 Figures\CORP Vicinity Map .dwg

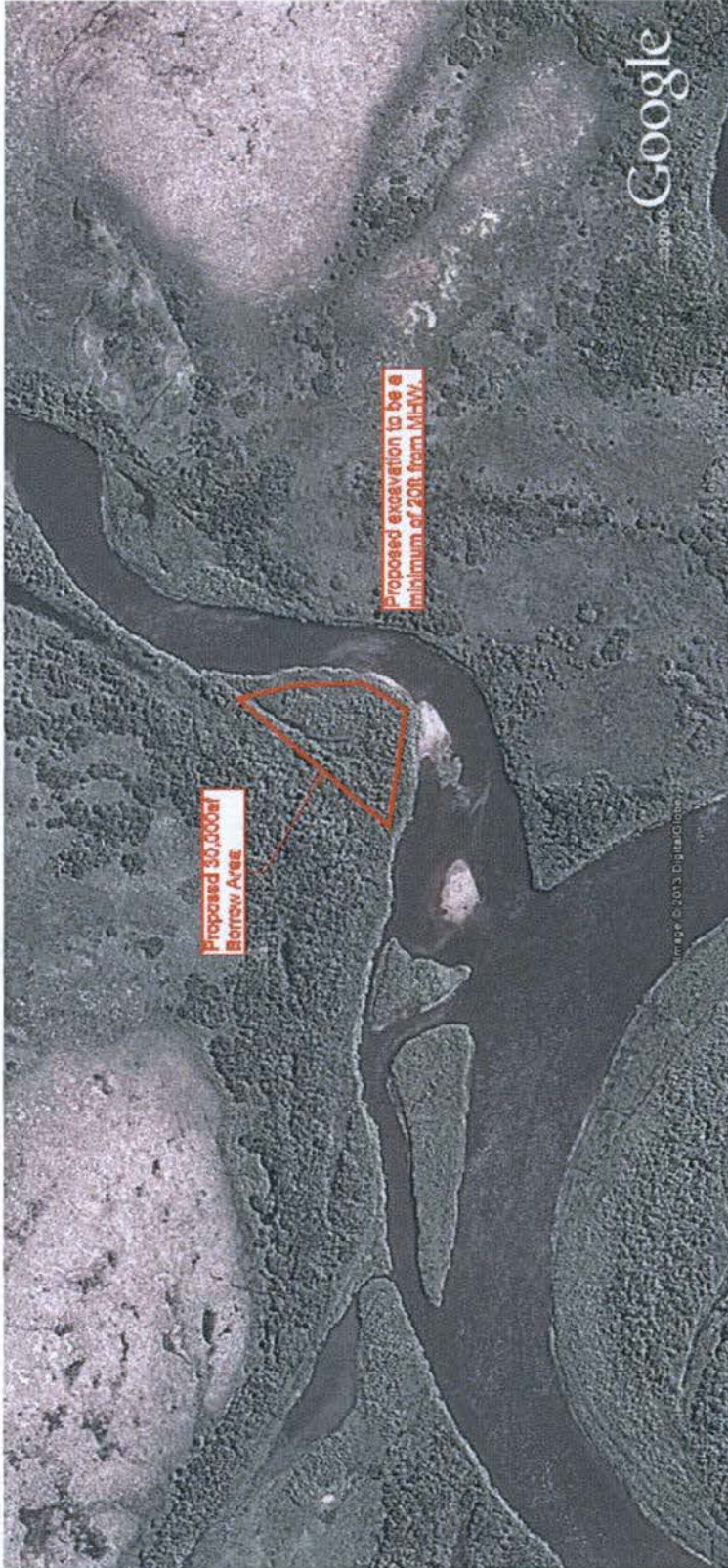

POA-2013-567, Eek River, Sheet 4 of 8, dated October 21, 2013

U.S. ARMY CORPS OF
ENGINEERS ALASKA DISTRICT
2204 3RD STREET
JBER, ALASKA 99506-0898

AGENT:
CRW ENGINEERING GROUP, LLC
3940 ARCTIC BLVD. SUITE 300
ANCHORAGE, AK 99503

**EEK SOLID WASTE FACILITY
EEK, ALASKA**

GRAVEL SITE 1 MAP

LOCATION: EEK, AK
SEWARD MERIDIAN T2N R73W
SECTIONS 31 AND 32

STATUS: PERMITTING

DATE: 10/21/2013

FIGURE:

FILE: \\Jobsturf\Jobsdata\82601.00 Eek Solid Waste Facility\00 CADD\02 Figures\CORP Vicinity Map .dwg

Page 1



POA-2013-567, Eek River, Sheet 5 of 8, dated October 21, 2013

10/18/2013

U.S. ARMY CORPS OF
ENGINEERS ALASKA DISTRICT
2204 3RD STREET
JBER, ALASKA 99506-0898

AGENT:
CRW ENGINEERING GROUP, LLC
3940 ARCTIC BLVD. SUITE 300
ANCHORAGE, AK 99503

EEK SOLID WASTE FACILITY EEK, ALASKA

GRAVEL SITE 2 MAP

LOCATION: EEK, AK
SEWARD MERIDIAN T2N R73W
SECTIONS 31 AND 32

STATUS: PERMITTING

DATE: 10/21/2013

FIGURE:

FILE: \\Jobstuff\Jobdata\82601.00 Eek Solid Waste Facility\00 CADD\01 Working Set\01 Civil\Old Landfills\Landfill Sections.dwg

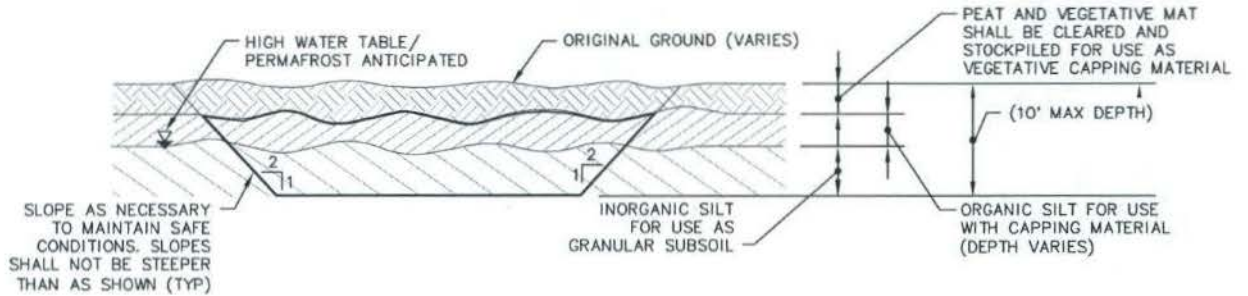

1 TYPICAL MATERIAL SOURCE EXCAVATION SECTION
Scale: NTS

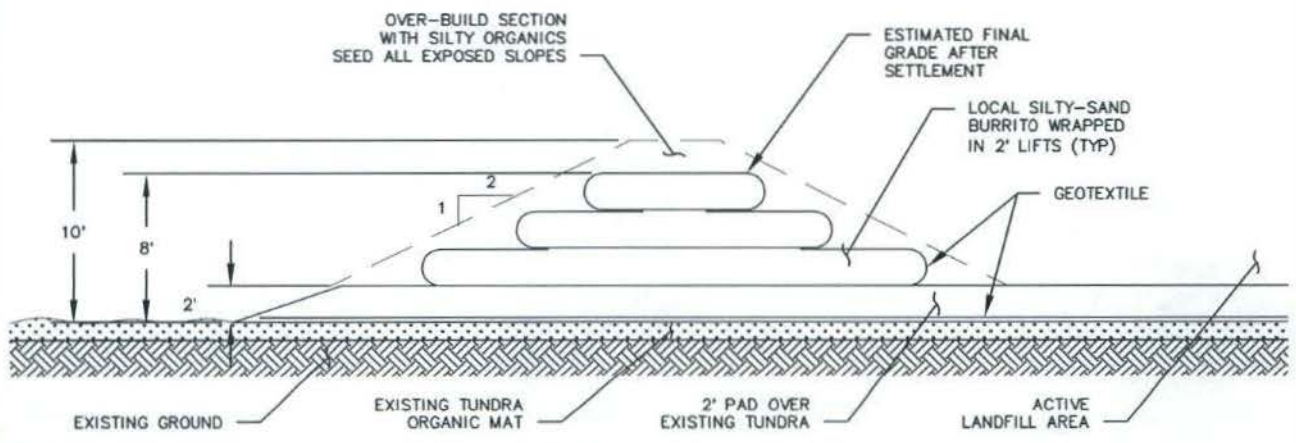

2 TYPICAL LANDFILL BERM SECTION
Scale: NTS

U.S. ARMY CORPS OF ENGINEERS ALASKA DISTRICT
2204 3RD STREET
JBER, ALASKA 99506-0898

AGENT:
CRW ENGINEERING GROUP, LLC
3940 ARCTIC BLVD. SUITE 300
ANCHORAGE, AK 99503

**E EK SOLID WASTE FACILITY
E EK, ALASKA**

TYPICAL SILT SECTIONS

LOCATION: EEK, AK
SEWARD MERIDIAN T2N R73W
SECTIONS 31 AND 32

STATUS: PERMITTING
DATE: 10/21/2013 FIGURE:

FILE: \\jobstuff\jobdata\82601.00 Eek Solid Waste Facility\00 CADD\02 Figures\BW CORP DETAILS.dwg

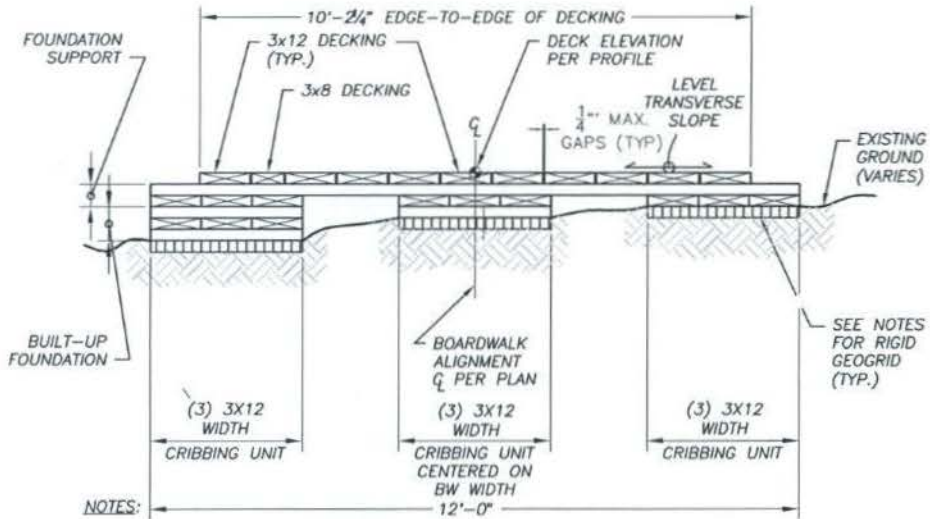

- NOTES:
1. AT-GRADE BOARDWALK IS SUPPORTED DIRECTLY ON EXISTING GROUND.
 2. WITH THE EXCEPTION TO ONE 3x8 DECKING UNIT, WHICH SHALL BE LOCATED AS SHOWN, TYPICAL BOARDWALK SECTION SHALL FEATURE 3x12 SIZE FOR ALL OTHER DECKING UNITS.

1 AT-GRADE BOARDWALK TYPICAL SECTION
Scale: NTS

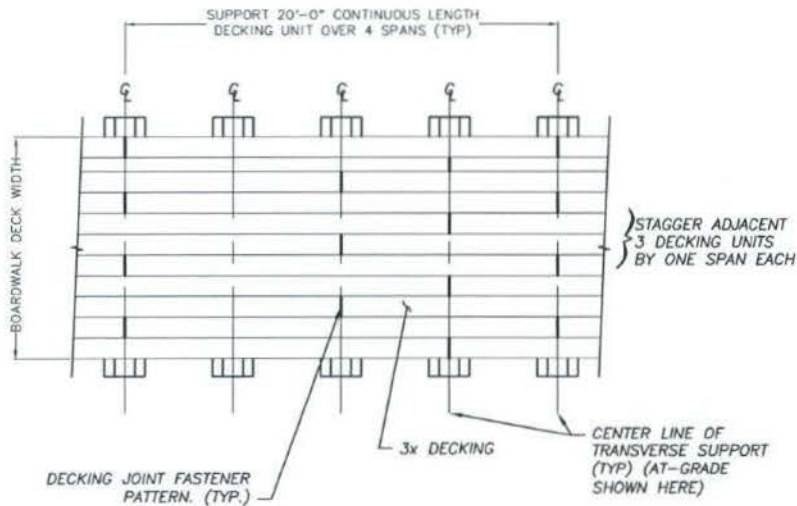

- NOTES:
1. THIS TYPICAL DECKING PATTERN PLAN APPLIES FOR NEW AT-GRADE.

2 TYPICAL DECKING PATTERN PLAN
Scale: NTS

U.S. ARMY CORPS OF
ENGINEERS ALASKA DISTRICT
2204 3RD STREET
JBER, ALASKA 99506-0898

AGENT:
CRW ENGINEERING GROUP, LLC
3940 ARCTIC BLVD. SUITE 300
ANCHORAGE, AK 99503

**E EK SOLID WASTE FACILITY
E EK, ALASKA**

**PROPOSED
AT-GRADE BOARDWALK**

LOCATION: EEK, AK
SEWARD MERIDIAN T2N R73W
SECTIONS 31 AND 32

STATUS: PERMITTING
DATE: 10/21/2013 FIGURE:

FILE: \\Jobstuf\Jobsdata\82601.00 Eek Solid Waste Facility\00 CADD\01 Working Set\01 Civil\Old Landfills\Landfill Sections.dwg

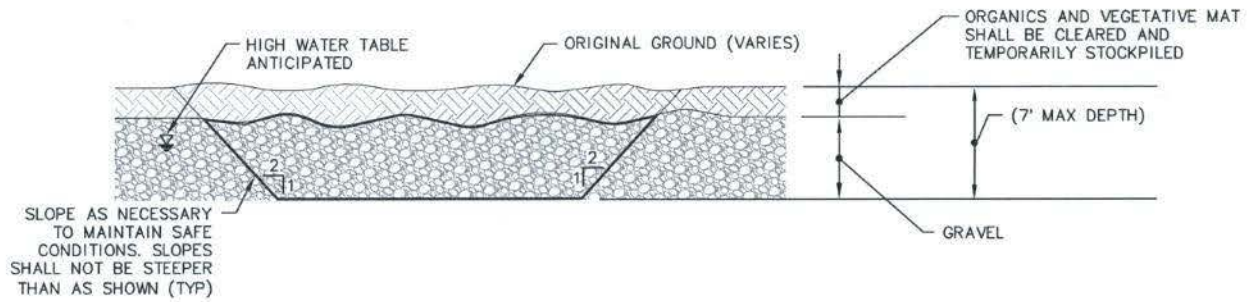

1 TYPICAL MATERIAL SOURCE EXCAVATION SECTION
Scale: NTS

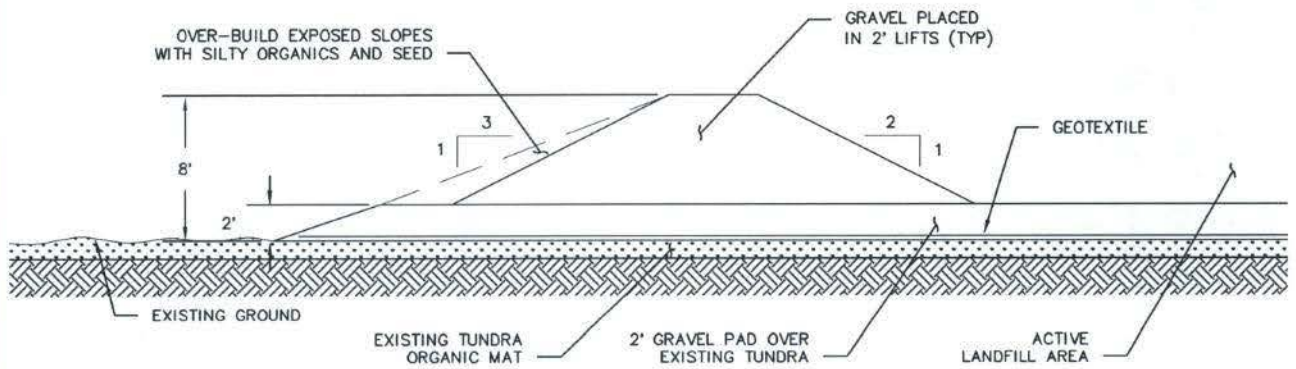

2 TYPICAL LANDFILL BERM SECTION
Scale: NTS

U.S. ARMY CORPS OF
ENGINEERS ALASKA DISTRICT
2204 3RD STREET
JBER, ALASKA 99506-0898

AGENT:
CRW ENGINEERING GROUP, LLC
3940 ARCTIC BLVD. SUITE 300
ANCHORAGE, AK 99503

**EEK SOLID WASTE FACILITY
EEK, ALASKA**

TYPICAL GRAVEL SECTIONS

LOCATION: EEK, AK

SEWARD MERIDIAN T2N R73W
SECTIONS 31 AND 32

STATUS: PERMITTING

DATE: 10/21/2013 FIGURE: